

# L180 One Piece Reduced Port Ball Valve

Size Range 1/4" - 2" ( DN8 - DN50 )  
 Pressure Rating 2000 PSI  
 Materials Barstock Type  
 End Connection Threaded  
 Service Application Water, Oil, Gas, Thermal Fluid,  
 Chemicals and others  
 Certifications ISO 9001-2008, PED 97/23/EC  
 Operation Manual

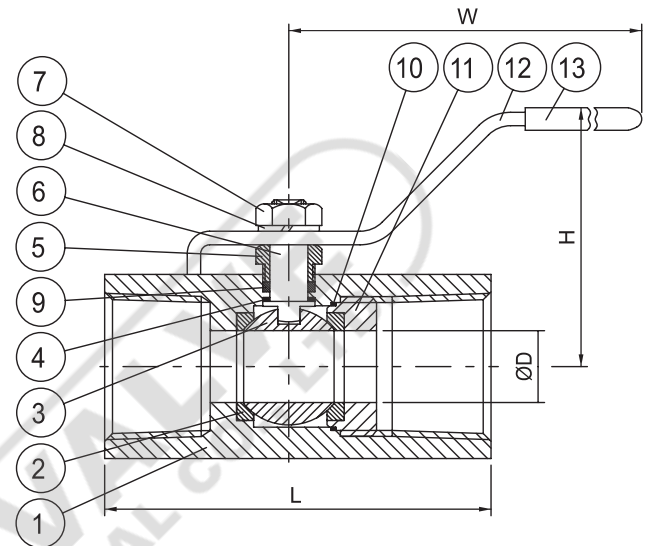
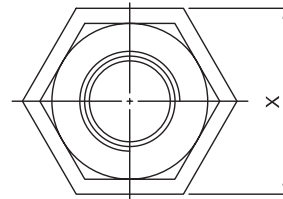

## MATERIAL LIST:

ITEM	DESCRIPTION	CARBON STEEL	Q'TY
1	BODY	ASTM A108 BARSTOCK TYPE	1
2	SEAT	PTFE / R-TFE	2
3	BALL	ASTM A351 CF8/304	1
4	THRUST WASHER	PTFE	1
5	GLAND	ZINC PLATED STEEL	1
6	STEM	ASTM A276 304	1
7	HANDLE NUT	ZINC PLATED STEEL	1
8	SPRING WASHER	ZINC PLATED STEEL	1
9	STEM PACKING	PTFE	1
10	BODY GASKET	PTFE	1
11	BODY INSERT	ASTM A108 CARBON STEEL	1
12	HANDLE	ZINC PLATED STEEL	1
13	SLEEVE	VINYL PLASTISOL	1

## P-T RATINGS

T PTFE    R R-TFE

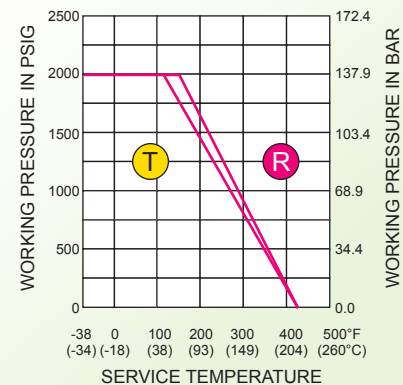

## DIMENSIONS:

SIZE		ØD		L		H		W		X		Weights KG
IN	DN	IN	MM	IN	MM	IN	MM	IN	MM	IN	MM	
1/4"	8	0.20	5	1.69	43	1.34	34	2.64	67	0.67	17.0	0.1
3/8"	10	0.28	7	1.85	47	1.34	34	3.15	80	0.83	21.0	0.1
1/2"	15	0.35	9	2.44	62	2.36	60	4.33	110	1.14	29.0	0.3
3/4"	20	0.47	12	2.76	70	2.52	64	4.33	110	1.38	35.0	0.5
1"	25	0.63	16	3.39	86	2.64	67	4.80	122	1.61	41.0	0.7
1 1/4"	32	0.79	20	3.70	94	3.11	79	5.83	148	2.24	57.0	1.4
1 1/2"	40	0.98	25	4.02	102	3.11	79	5.83	148	2.24	57.0	1.4
2"	50	1.26	32	4.49	114	3.54	90	6.06	154	2.85	72.5	2.6